

CYLINDERS

SINGLE-ACTING CENTER HOLE

Simplex Hard-Kor™ Cylinders Make Light Work Of Structural Reconstruction.



Damage from earthquakes and age, caused the roof of the Mission San Juan Capistrano to be in need of repair. 24 Simplex RC121 cylinders were used to transfer the load, so repairs could be made.

- 12 standard models.
- **HARD-KOR™ DESIGN!**
- No potential leak points at base.
- Extra protection against base blow-out.
- Low profiles for more versatility.
- Double wipers protect against contamination.
- Faster retraction increases productivity.
- Large center holes for greater flexibility.
- Rhino-Rod™ pistons resist scoring & corrosion.
- Lower operating pressures.
- Doubles as lifting cylinder.
- High flow coupling with tough rubber dust cap.
- Precision construction that prevents seal extrusion.

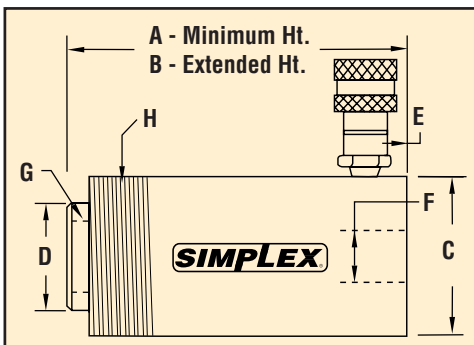

Base Mounting Holes

Capacity	Thread		Bolt Circle Dia. (in)
	Size (in)	Dpth. (in)	
12 Ton	5/16-18	5/16	2
20 Ton	3/8-16	7/16	3 1/4
30 Ton	3/8-16	3/8	3 5/8
60 Ton	1/2-13	7/16	5 1/8
100 Ton	5/8-11	3/4	7

Optional Threaded Saddles

AS20			AS30		
A	B	C	A	B	C
54	1-8	.38	63	1.25-7	.38

Single-Acting Center Hole Cylinders 12 Through 100 Ton Capacities

Model Number	Cap. (tons)	Stroke (in)	A Min. Ht. (in)	B Ext. Ht. (in)	Effect Area (sq in)	Pres. @ Cap. (psi)	Oil Cap. Req'd (cu in)	C Body O.D. (in)	D Piston O.D. (in)	E Base To Port C/L (in)	F Center Hole Dia. (in)	H		G		Wgt. (lbs)
												Collar Thrds. (in)	Collar Thrd. Lgth. (in)	Piston Thrds. (in)	Piston Thrd. Lgth. (in)	
RC120	12	5/16	2 3/16	2 1/2	2.36	10,185	.90	2 3/4	1 3/8	7/16	49/64	2 3/4 - 16	1 13/16	3/4 - 16	5/8	3.5
RCQ120		3/4 - 10														
RC121		1 5/8	4 3/4	6 3/8										25/32	5/8	
RC1211		3	7 1/4	10 1/4										----	----	
RC123	20	2	6 3/16	8 3/16	5.30	7,545	11	4	2 1/8	51/64	1 1/16	3 7/8 - 12	1 1/2	1 9/16 - 16	3/4	17
RC202		6	11 3/16	17 3/16										32		31
RC206	30	2 1/2	7	9 1/2	8.64	6,950	22	5	2 1/2	13/16	1 5/16	4 1/2 - 12	1 3/4	1 13/16 - 16	7/8	26
RC302		6 1/8	12 1/4	18 3/8										64		52
RC306	60	3	8 21/32	11 21/32	14.58	8,230	44	6 3/4	4	13/16	2 1/8	6 1/4 - 12	2	2 3/4 - 16	3/4	68
RC603		6	12 21/32	18 21/32										88		80
RC606	100	3	9	12	20.60	9,700	62	8 1/4	5	1	3 1/8	----	----	4 - 16	1	99
RC1003																